

Koh Development Custom Electrophoresis Glass Order Form

www.koh-development.com
 1884 Canova St. SE; Palm Bay, FL 32909
 Phone: (321) 872-0940; Fax: (321) 821-1819
 support@koh-development.com

Bill To:

Organization:	
Address:	
PO#	

Ship To:

Organization:	
Contact:	
Address	
Phone:	
Email:	

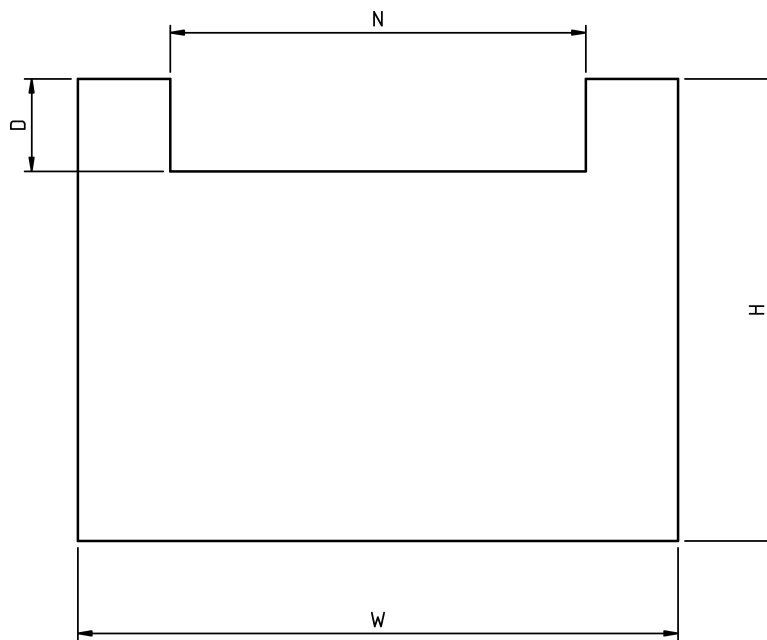

Specify the Dimensions

Quantity	D	N	H	W	Thickness ¹

Notes:

1. Thicknesses 0.125", 0.188", 0.250" (3mm, 4.5mm, 6.0mm) available.
2. If unnotched glass is desired, leave the notch dimensions blank or set them to zero.

Attach any notes and fax or email it to us.

